

# Semi automatic Cutting system

The perfect automation solution for your finishing - whether for commercial printing, online printing and pharmacy.

## Components (from right to left)

- BASA Evolution
- High speed cutter BP 132
- Unloader BA 3



*\*Image similar (machine color: anthracite, light barrier BA 3 not shown)*

## Workflow

Feeding of the **BASA** by the operator. Separation and break-up of the partial layers and fully automatic jogging of the cutting layer. The machine now processes the entire pallet fully automatically and forms accurately edged layers at the preset height. Partial layer height and air supply can be changed individually. An integrated unloading pusher transfers the perfectly jogged, aligned and pressed layers directly to the rear table of the **BP 132** high-speed cutter.

The **BP132** high-speed cutter guarantees an efficient and ergonomic cutting process.

The modular buffer and conveyor systems ensure sufficient flexibility between the jogging and cutting processes. The **BA 3** unloader is loaded by the operator and automatically stacks single or multiple blanks with high precision.

## Customer benefits

- Fully automatic jogging process
- Parallel processes jogging and cutting for high productivity
- Ergonomic work / less physical stress
- Reduction of personnel costs
- Minimum set-up times/ simple operation

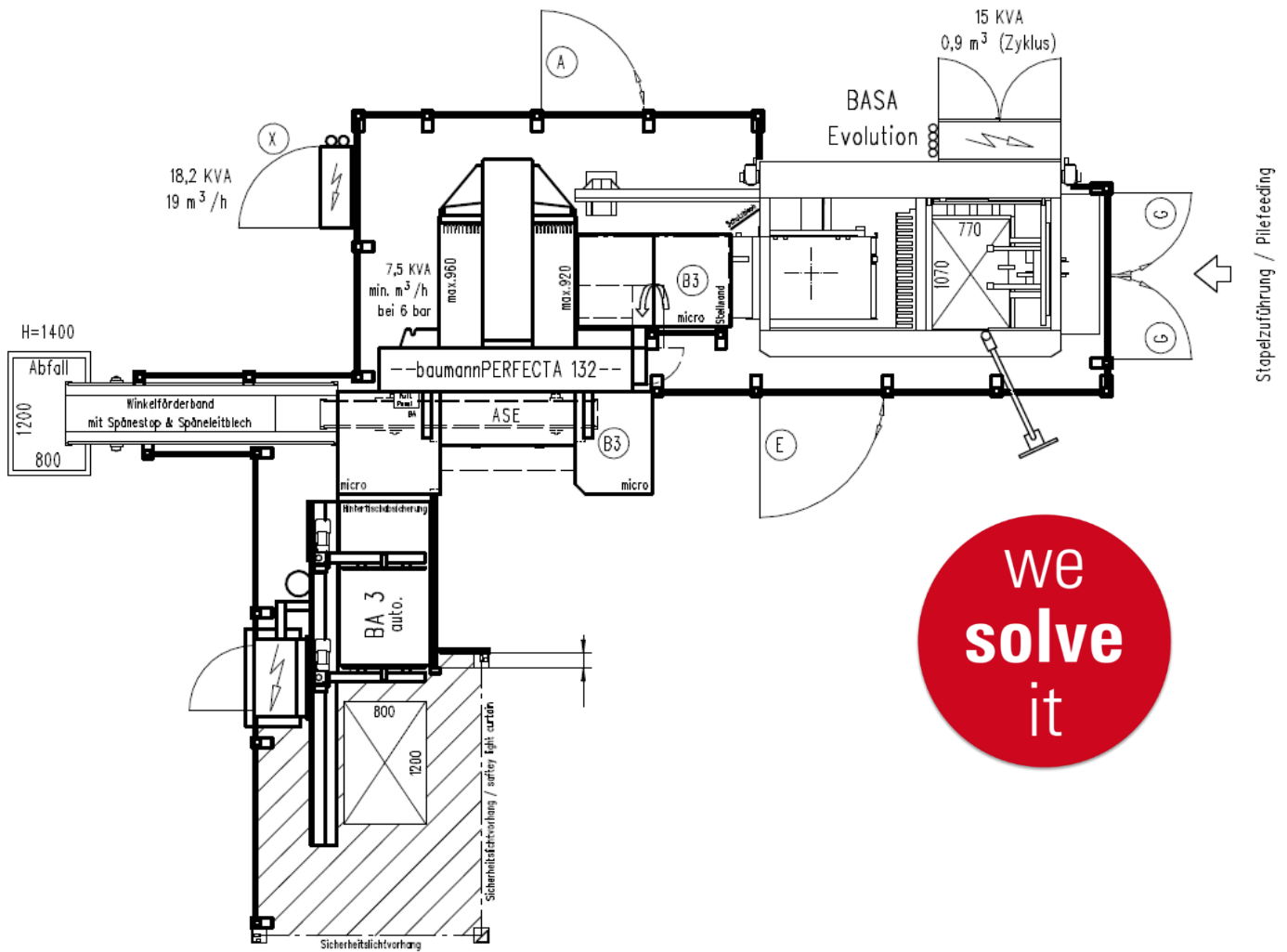

## Optimal application areas

- 2 Shift operation
- Multiple forms/collective forms
- From 5 cutting layers / job
- Sheet format B3

## Technical data

### Automatic Jogging system BASA evolution

min. sheet format:	400 x 600 mm
max. sheet format:	770 x 1070 mm
output:	up to 25.000 sheets/hour

### High-speed cutter BP 132

max. cutting length:	1320 mm
max. operating height:	165 mm
rest cut without/with false clamp:	20/77 mm

### Unloader BA 3

min. sheet format:	400 x 400 mm*
max. sheet format:	770 x 1070 mm

\*The inherent stability of the stack must be given.

Version: 06/2023. Subject to technical changes.